



●縦型チップ 105°C品

●VERTICAL CHIP TYPE 105°C USE

EC-LDシリーズ

JIS C 5101
CE-32
(耐洗浄品)

TYPE EC-LD

JIS C 5101
CE-32
(Washable product)

■特徴

- ・105°C、3000時間保証品
- ・高さ 4.5mm品

■FEATURES

- ・It's guaranteed for 105°C as well as 3,000 hours.
- ・Height 4.5mm product

■性能/PERFORMANCE SPECIFICATIONS

カテゴリ-温度範囲	CATEGORY TEMPERATURE RANGE	-40°C ~ +105°C						
標準静電容量許容差	STANDARD CAPACITANCE TOLERANCE	±20% (120Hz, 20°C)						
漏れ電流 (最大値)	LEAKAGE CURRENT (MAX.VALUE)	I=0.01CV OR 3 μA WHICHEVER C=RATED CAPACITANCE (μF) IS THE GREATER (after 2 minutes) V=RATED VOLTAGE (V)						
損失角の正接 (最大値) (tan δ)	DISSIPATION FACTOR (MAX.VALUE) (tan δ)	WV	6.3	10	16	25	35	50
		tan δ	0.35	0.30	0.20	0.16	0.14	0.12
耐久性 105°C, 3000時間 定格電圧印加	ENDURANCE APPLICATION OF RATED VOLTAGE, AT 105°C FOR 3000 hours.	CAPACITANCE CHANGE LESS THAN ±30% OF THE INITIAL MEASURED VALUE DISSIPATION FACTOR: LESS THAN 300% OF THE INITIAL SPECIFIED VALUE LEAKAGE CURRENT: LESS THAN THE INITIAL SPECIFIED VALUE						
低温特性 120Hz +20°Cを基準とする。	LOW TEMPERATURE STABILITY RATIO OF IMPEDANCE AT COLD TO THAT AT 20°C, 120Hz. MAX. VALUE	WV	6.3	10	16	25	35	50
		-25°C/+20°C	4	3	2	2	2	2
		-40°C/+20°C	10	8	6	4	4	4

■寸法図 / DIAGRAM OF DIMENSIONS

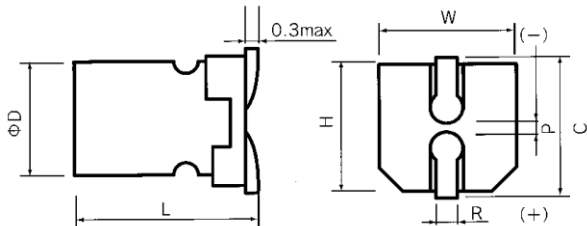

D+0.5max	L+0.1/-0.2	W±0.2	H±0.2	C±0.2	R	P
6.3	4.5	6.6	6.6	7.3	0.5~0.8	2.2

P: 参考寸法

■寸法表 (φD×L) / SIZE TABLE (φD×L)

Cap. (μF)	6.3 (0J)		10 (1A)		16 (1C)		25 (1E)		35 (1V)		50 (1H)	
	φD×L (mm)	Ripple (mArms)	φD×L (mm)	Ripple (mArms)	φD×L (mm)	Ripple (mArms)	φD×L (mm)	Ripple (mArms)	φD×L (mm)	Ripple (mArms)	φD×L (mm)	Ripple (mArms)
10											6.3×4.5	24
22							6.3×4.5	33	6.3×4.5	35		
33					6.3×4.5	36	6.3×4.5	40				
47			6.3×4.5	38	6.3×4.5	43	6.3×4.5	44				
100	6.3×4.5	49	6.3×4.5	52								

Ripple Current: 120Hz, 105°C

■品番ご指定法/HOW TO SPECIFY NUMBER

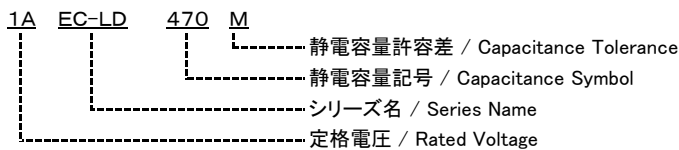

Exp. 100: 10 μF, 220: 22 μF, 101: 100 μF